

200-250

4x2 CAB/CHASSIS - CREW CAB

MODEL:	GVM:	ORDERING CODE:
NKR 200 Short	4490kg	8CL02-111
NKR 200 Medium	4490kg	8CN02-111
NKR 250 Crew	5200kg	8CN03-111

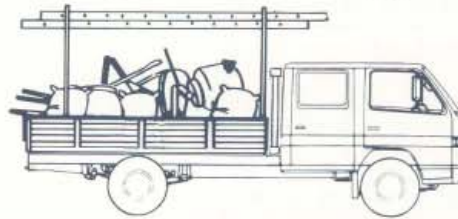
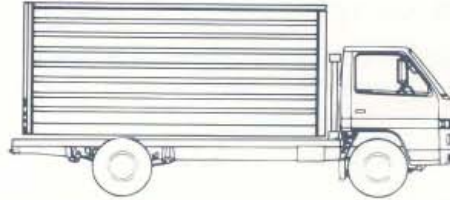

ISUZU

MODEL RANGE SUMMARY

	ENGINE	TRANS- MISSION	AXLE FRONT (kg)	AXLE REAR (kg)		WHEELBASE (mm)		*BODY LENGTH (mm)	BRAKES
				Capacity	RATIO:1				
	ISUZU 4BE1 3.6l	ISUZU MSA5G 5 speed overdrive	2200 Capacity	4000 Capacity		2460	3360		Dual Hydraulic with vacuum servo
NKR 200 SHORT	●	●	●	●	5.857	●		3200	●
NKR 200 MEDIUM	●	●	●	●	5.857		●	4570	●
NKR 250 CREW CAB	●	●	●	●	5.857		●	3650	●

RATINGS

	GVM (kg)	GCM (kg)	TYRES	ESTIMATED KERB MASS (kg) •			MAX GEARED SPEED (km/h)
				Front	Rear	Total	
NKR 200 SHORT	4490	6490	7.00 - 16LT-8 Ply (Opt) 7.00R 16LT-8 Ply	1220	630	1850	106
NKR 200 MEDIUM	4490	6490	7.00 - 16LT-8 Ply (Opt) 7.00R 16LT-8 Ply	1230	650	1880	106
NKR 250 CREW CAB	5200	6800	7.00 - 16LT -8 Ply (F)-10 Ply (R) (Opt) 7.00R 16LT -8 Ply (F)-10 Ply (R)	1300	720	2020	106

• Chassis and cab with oil, water and fuel tank containing 10 litres of fuel.

• Subject to weight distribution.

Body Builder's note: New lighting regulations have now been enforced, please refer to the relevant ADRs for full body fitment regulations.



MECHANICAL Cab/Chassis Components

		NKR 200 SHORT	NKR 200 MED.	NKR 250 CREW
AXLE	FRONT ■ Type: Reverse Elliot I-beam ■ Capacity: 2200 kg	●	●	●
	REAR ■ Type: Banjo, fully floating ■ Capacity: 4000 kg ■ Final gear: 292mm diameter ■ Hypoid Ratio: 5.857:1	●	●	●
BRAKE	SERVICE ■ Type: Hydraulic, dual circuit, front two leading, rear dual two leading ■ Total lining area: 1752 cm ²	●	●	●
	PARKING Type: Mechanical, at rear of transmission	●	●	●
CAB	EXTERIOR ■ All steel tilt cab ■ Laminated windshield 2 speed wiper/washer ■ West coast type rear view mirrors with wiring in door for clearance lamps ■ Four rectangular sealed beam headlamps ■ Large aluminium entry steps to each side (front) ■ Energy absorbing bumper ■ General hand tools ■ 4000 kg jack	●	●	●
	■ Vertical exhaust			●
	■ Vertical air intake stack	●	●	
	INTERIOR ■ Seats: Driver - adjustable and reclining bucket seat with lumbar support (not Crew Cab) ■ 2 seater passenger seat ■ Retractable lap-sash seat belts on outboard seats, lap centre ■ Front side quarter vent windows ■ AM/FM clock radio ■ Heater/demister with 3 speed fan ■ Windshield washer tank located in passenger door ■ Driver and passenger sunvisors ■ Padded roof lining ■ Easy access pull down fuse cover ■ Optional air conditioning	●	●	●
	■ Seat material: -cloth	●	●	
	-vinyl			●
	■ 3 seater rear passenger compartment ■ Rear floor mat			●
	INSTRUMENTATION ■ Speedometer with odometer/tripmeter ■ Tachometer ■ Gauges: Engine coolant temperature and fuel level	●	●	●
	■ Indicator Lamps: Turning indicators, headlamp high beam and park brake engaged	●	●	●
	■ Warning Lamps: Oil pressure, brake failure, low battery charge, fuel level, coolant level and glow plug	●	●	●
	■ Switches: Left side combination switch for windshield wash/2 speed windshield wipers Right side combination switch for turn signals and headlamps Key operation for engine start and stop	●	●	●
	CLUTCH	■ Type: Hydraulic control. Dry single plate with diaphragm spring. ■ Size: 275mm diam. ■ Asbestos-free	●	●
ELECTRICAL SYSTEM ■ Batteries: 2 x 12 V 50 A/H ■ Alternator: 24V - 20A ■ Starter: 24V - 3.5kW		●	●	●

		NKR 200 SHORT	NKR 200 MED.	NKR 250 CREW
ENGINE	ISUZU 4BE1 ■ Type: 4 cylinder direct injection diesel ■ Bore x stroke (mm) 105 x 105 ■ Displacement 3636 (cc) ■ Compression ratios (:1) 17.5 ■ Output- Power (kW) 74 @ 3500 rpm (DIN Nett) ■ Torque (Nm) 242 @ 2000 rpm (DIN Nett)	●	●	●
	LUBRICATION ■ Pressure feed with full flow paper element oil filter and partial flow sub filter ■ Capacity 7.5 litres, including filter	●	●	●
	COOLING ■ Plastic fan - 8 blade ■ Size: 400mm dia. ■ Radiator size: 547h x 471w x 54t (mm)	●	●	●
	AIR CLEANER ■ Paper element, cartridge type ■ Mounted under cab floor ■ Vertical air intake behind cab	●	●	●
	EXHAUST ■ Horizontal pipe ■ Vertical pipe	●	●	●
FUEL SYSTEM	■ Injection pump: In line plunger, Bosch 'A' type. Fuel/water sedimentor with warning lamp	●	●	●
	■ Fuel tank capacity: 75 litres	●		
	■ Fuel tank capacity: 90 litres			●
	■ Fuel tank capacity: 100 litres		●	
FRAME	■ Type: Ladder type channel section ■ Side member dimensions: 170 x 65 x 4.5 (mm)	●	●	●
	STEERING ■ Type: Recirculating ball ■ Gear ratio: 26-30:5:1	●	●	●
SUSPENSION	FRONT ■ Type: Semi-elliptical, alloy steel leaf springs ■ Shock absorbers: hydraulic, double acting telescopic ■ Size: l x w (mm): 1140 x 60 x 7 leaves	●	●	●
	REAR ■ Type: Semi-elliptical, alloy steel leaf springs ■ Shock absorbers: hydraulic, double acting telescopic ■ Size: l x w (mm) main: 1250 x 70 x 4 leaves auxiliary: 850 x 70 x 5 leaves	●	●	●
TRANSMISSION	■ Type: Isuzu 5 speed overdrive (MSA5G) with short remote gear shift lever ■ Gear Ratios: 1 - 1st 2nd 3rd 4th 5th Rev 5.788 2.998 1.594 1.000 0.776 5.798	●	●	●
TYRES	Tyre Size: 7.00 - 16LT 8 ply (Olympic Trojan 56)	STD F/R	STD F/R	STD F
	7.00 - 16LT 10 ply (Olympic Trojan 130)			STD R
	7.00R - 16LT 8 ply (Goodyear G22)	OPT F/R	OPT F/R	OPT F
	7.00R - 16LT 10 ply (Goodyear G22)			OPT R
WHEELS	Wheel type and size: 5.50 Fx16-5 stud	F/R	F/R	F/R

4BE1 ENGINE PERFORMANCE

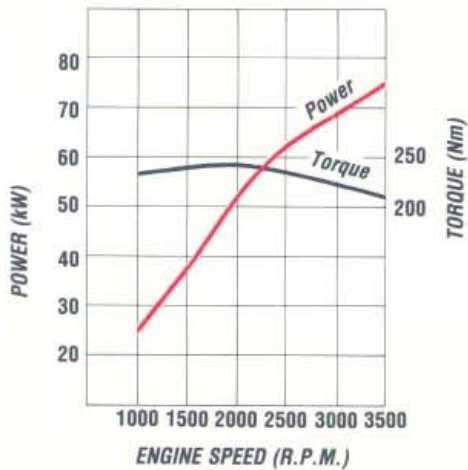

ISUZU 4BE1

Type: 4 Cylinder direct injection diesel ■ Bore x stroke (mm) 105 x 105
 ■ Displacement 3636 (cc) ■ Compression ratio (:1) 17.5 ■ Output-Power (kW)
 74 @ 3500 rpm (DIN Nett) ■ Torque (Nm) 242 @ 2000 rpm (DIN Nett)

DIMENSIONS

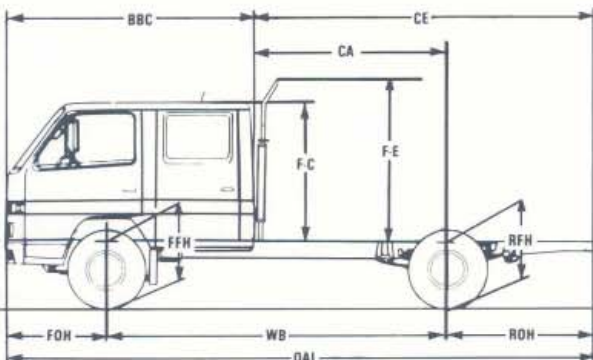
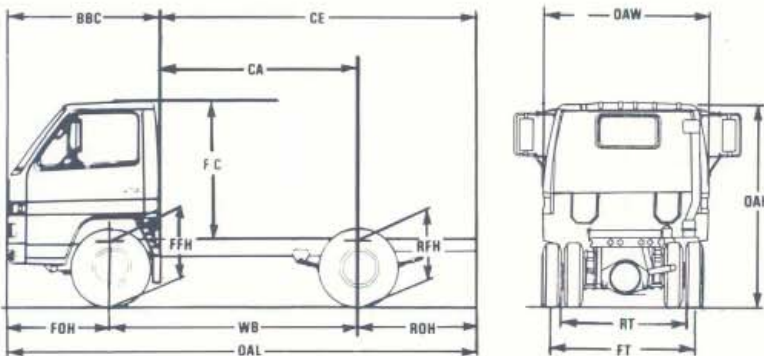
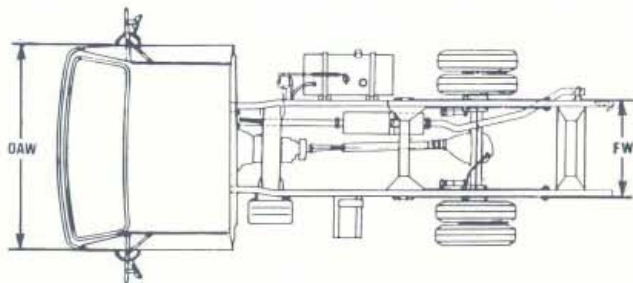

	NKR 200 SHORT	NKR 200 MED.	NKR 250 CREW
OAL (Overall length)	4610	5830	5830
WB (Wheelbase)	2460	3360	3360
CA (Cab to axle)	1985*	2885*	1930*
CE (Cab to end of frame)	3120*	4340*	3385*
ROH (Rear overhang)	1135	1455	1455
FOH (Front overhang)	1015	1015	1015
BBC (Bumper to back of cab)	1490	1490	2445
OAW (Overall width)	1690	1690	1690
FW (Frame width)	700	700	700
FT (Front track)	1385	1385	1385
RT (Rear track)	1425	1425	1425
FFH (Front frame height) *	660	660	660
RFH (Rear frame height) *	750	750	750
FC (Frame to top of cab)	1345	1345	1380
FE (Frame to top of exhaust)	—	—	2480
OAH (Overall height to top of cab)	2020	2020	2020
TURNING CIRCLE (m) kerb to kerb	11.0	14.4	14.4
* At kerb mass *CA and CE dimensions are effectively reduced by 95mm with fitment of vertical air intake. *CA and CE dimensions are effectively reduced by 200mm with fitment of vertical exhaust pipe.			

ISUZU-GENERAL MOTORS AUSTRALIA LTD. A.C.N. 006 962 572 12/20 WARRANTY.

Every Isuzu truck is covered by the I-GM New Vehicle Warranty which covers your vehicle for the first 12 months or 20,000 kilometres.

PLEASE NOTE: As the policy of Isuzu-General Motors Australia Ltd. is one of continual product improvement, all specifications and equipment are subject to change without notice. Bodies illustrated are not standard.

No I-GM Dealer or other person is authorised or permitted to give or make any statement, assertion or undertaking in relation to the quality performance characteristics descriptions or fitness for any purpose of any I-GM product or in connection with the supply of any I-GM product which is at variance with any written statement assertion or undertaking on any of these subjects given or made by Isuzu-General Motors Australia Ltd. in its published sales literature, and the company accepts no liability for any such unauthorised action. Isuzu-General Motors Australia Ltd. have franchised dealers in many parts of Australia for the sale of service parts and the provision of service to owners of I-GM products. Every endeavour is made to ensure that such dealers carry adequate stocks of service parts, and are equipped to provide satisfactory service, but makes no promise, other than that contained in the New Vehicle Warranty given by Isuzu-General Motors Australia Ltd. that such parts or service facilities will be available, or available at any specific location or any particular time.